

Integrated Suspension and Axle Assembly

Watson & Chalin continues to offer industry leading technology with their Truck and Trailer Steerable lift axle families. The Tru-Track family represents 30 years of experience, technology and durable products being offered by W&C.

The **SL20K Tru-Track** member offers the industry a lightweight, compact design backed by an industry leading 5-year limited warranty*. When spec'ing a vocational tractor, remember W&C for cost effective, durable products that help protect your bottom line.

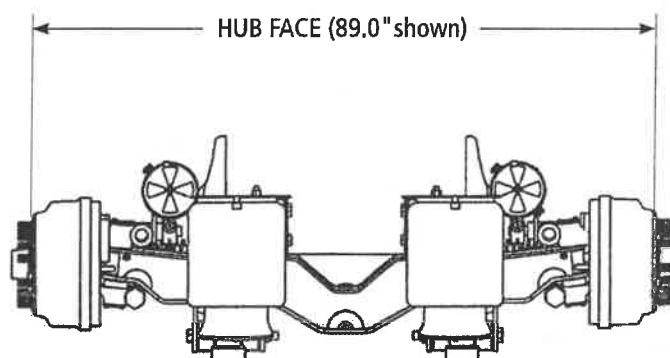
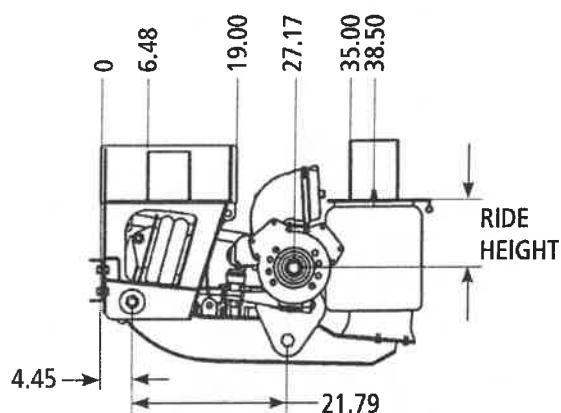

SL20K Specifications

Capacity:	20,000 pounds
Weight:	1,500 pounds
Travel:	12 inches
Lift:	8 inches
Ride Heights:	9.5 to 19 inches
Wheel Cut:	25 degrees
Packaging Space:	22.1 inches

- Fabricated axle, industry components
- Quick-change ride height system
- Reverse lock-out kit available
- Preset caster
- Parallelogram design
- Factory pre-plumbing available

* Contact your local Watson & Chalin representative for complete warranty terms, conditions and limitations.

Contact Watson & Chalin at 800.445.0736 or 972.547.6020 for additional information.



Watson & Chalin Manufacturing Inc.
725 E. University Drive, McKinney, Texas 75069
972.547.6020 • 800.445.0736 • Fax 972.542.0097
www.watsonsuspensions.com



20K TRU-TRACK

SELF-STEERING AXLE AND LIFT SUSPENSION SYSTEM

SL SERIES

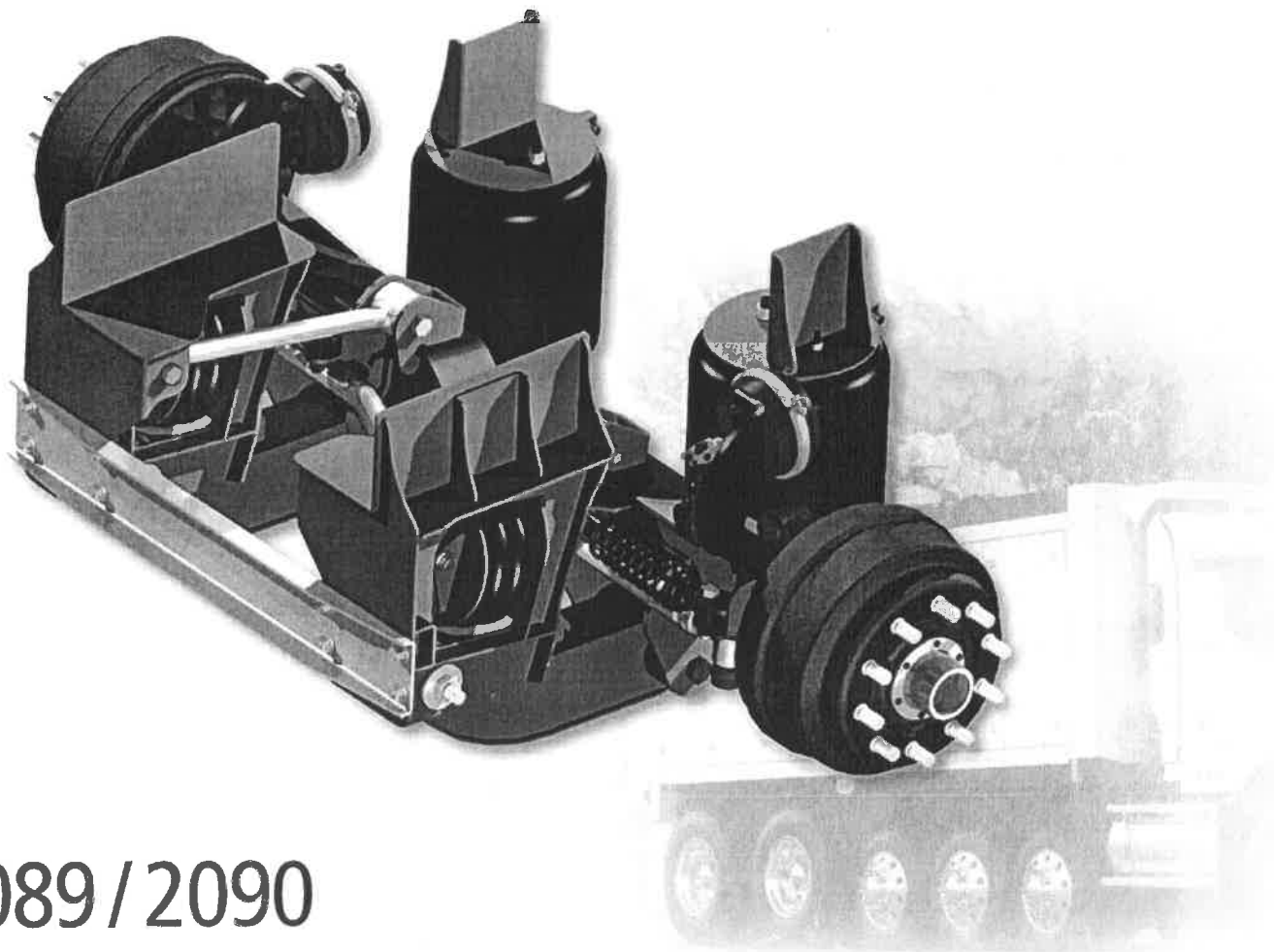

SL-2089/2090

The **SL20K Tru-Track** with a rated capacity up to 20,000 pounds is one of the best sellers in the Tru-Track family and is ideal for dump trucks. It incorporates our **quick-change** ride height system. This steerable lift axle is light weight yet durable utilizing Huck fasteners at the pivot points.

- 20,000 pound suspension capacity
- Compact packaging design of 22.1 inches - SSR
- Ride Heights: 9.5 thru 19 inches
- Maintenance-free Huck fasteners
- 5-year limited warranty*

* Contact your local Watson & Chalin representative for complete warranty terms, conditions and limitations.

Delivering Suspension Solutions

W[®]C
WATSON & CHALIN

For more information, call 800.445.0736

REMEMBERED PRODUCTS

SHOW ALL

RECENTLY VIEWED PRODUCTS



SL20K-2089

SL 208994 TT-10

hide

TRUCK > STEERABLE LIFT AXLES > SL20K-2089

SL20K-2089

+ Share

20K

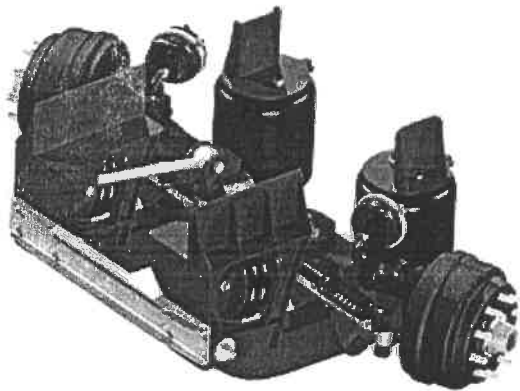

SELF-STEERING AXLE & SUSPENSION SYSTEM -
5 Year Warranty, Parallelogram Design, 20,000 lb.
Capacity

FEATURES & BENEFITS

SPECIFICATIONS

PARALLELOGRAM DESIGN
LIGHTWEIGHT: 1,490 LBS.
FABRICATED AXLE, INDUSTRY
STANDARD COMPONENTS
DUAL SELF-CENTERING STABILIZERS
PRESET CASTER
25° WHEEL CUT
WARRANTY: 5 YEARS

LITERATURE

SALES LITERATURE

W&C130 - SL-2089 Flyer REV
- 05/14 220k

